

# **HS5810 Tornado 2**

## **Hi-Speed Hand Dryer**

### **Installation and Operating Instructions**



**TORNADO 2**  
HI-SPEED HAND DRYER

#### **IMPORTANT SAFEGUARDS**

**WHEN USING ANY ELECTRICAL APPLIANCE, BASIC SAFETY  
PRECAUTIONS SHOULD ALWAYS BE FOLLOWED.**

**PLEASE READ ALL INSTRUCTIONS CAREFULLY  
AND RETAIN FOR FUTURE REFERENCE.**

**IF IN ANY DOUBT ABOUT THE INSTALLATION OR USE OF THIS  
PRODUCT, CONSULT A COMPETENT ELECTRICIAN.**

 **HEATSTORE**

The HS5810 TORNADO 2 is a stylish, hi-speed hand dryer for commercial applications. It has an antibacterial coating for added hygiene, can blow hot or cool air – settable on installation. It is fitted with a self-diagnostic function and has tamper-proof controls.

### **Important Safety Information – Please Read before Proceeding**

- The information contained in these installation instructions must be read carefully before any attempt to install the hand dryer.
- Failure to accurately follow these instructions may result in the incorrect operation of the unit, damage to property and/or personal injury.
- Heatstore will not be held liable for any damage to property or personal injury as a result of failure to comply with the instructions contained herein.
- All electrical installation and repair work should be carried out by a qualified electrician in accordance with current UK IEE regulations and any local codes or regulations.
- Any maintenance to this appliance should be carried out by a qualified electrician.
- This product must be earthed.
- Isolate power to the device before installation or servicing.
- Check that the electrical supply corresponds to that shown on the rating plate on the device.
- NOT to be used for any purpose other than drying hands.

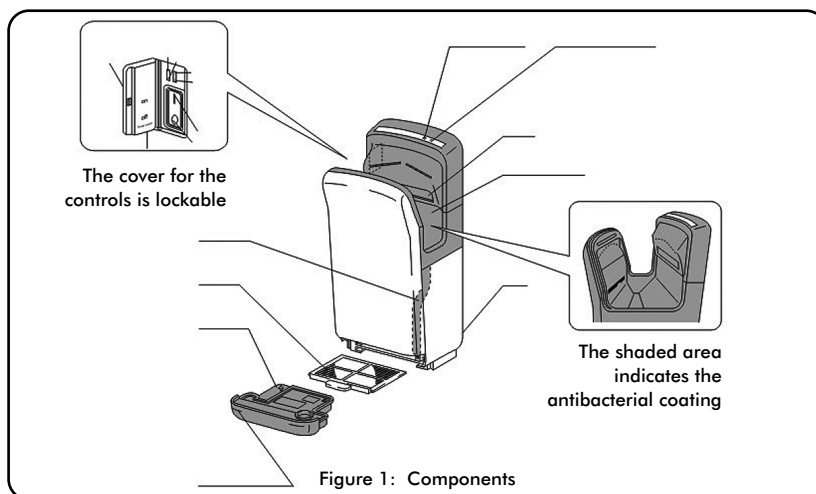

## Before installation

- Be sure to select a suitable position where the unit is easy to use, and away from direct sunlight, high condensation or corrosive elements. Choose a flat surface, away from high traffic. The unit is IPX4 rated.
- Make certain that you have all the parts and appropriate tools for installation.
- Be sure that the electrical supply (via a switched fuse spur/connection box to which you intend to connect the device) has been isolated/switched off to reduce the risk of electric shock.
- Ensure that there is no pipe work or electrical cables located directly within the drilling area.
- All pole-disconnection must be incorporated in the fixed wiring in accordance with applicable wiring regulations.

## Installation

### Note

*This unit is equipped so that it can blow hot and cool air when in operation. This may be set using the switch under the tamper-proof flap on the top left-hand side of the unit, and should be set during the installation of the appliance – see figure 2/2a.*

### Electrical

- Use a single-phase alternating current 220V-240V power supply.
- This unit comes pre-wired ready for installation.

### Installation

The left side of the unit must be at least 150mm away from any walls to allow access to the control panel.

Before 'offering up' the backplate and marking the wall:

- remove the drain tank as you would for cleaning – see page 6.
- remove the cover by removing the 2 screws behind the drain tank – see figure 3.
- remove the one screw located behind the drain tank to remove the back plate.
- remove the separate backplate from the main unit ready for fixing to the wall.



Figure 2



Figure 2a

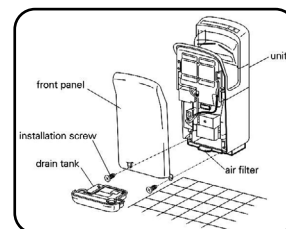

Figure 3: retaining screws

- Offer up the separate backplate to the wall and mark the position of the four holes and drill to a suitable depth – see figure 4.
- loosely fix the backplate to the wall and pull the fixed power cord through to the backbox.
- tighten the screws holding the backplate to the wall.
- attach the rear of the main unit to the 3 hooks on the backplate panel, and secure with the installation screws – see figure 5. *NOTE: These installation screws for the unit will not tighten completely if the hooks at the bottom of the installation panel are not in place. ensure the lower hooks are completely hooked onto the rear of the unit.*
- Re-attach the cover using the two screws located behind the drain tank.

### Fixed wiring

This unit comes pre-wired ready for installation via a suitable rated fused spur.

*All wiring must be in accordance with the current IEE regulations or any local codes or regulations.*

- Once the wiring has been completed, switch on electrical supply.

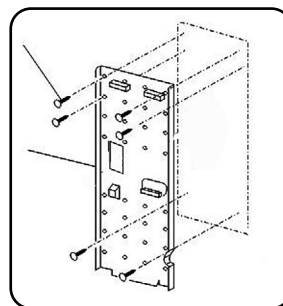

Figure 4

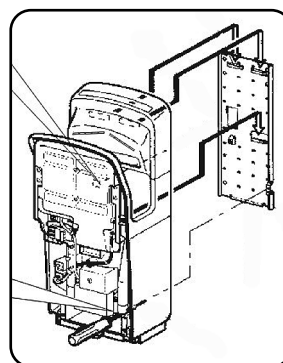

Figure 5

## Before using the hand dryer for the first time

Before using the hand dryer for the first time, be sure it is set up the way you want it to operate, with either hot or cool air blowing.

### Hot or cool air blowing

- Be sure the power is switched off.
- Open the tamper-proof switch cover on the left-hand, top side of the unit.
- Use the top right hand switch to select **HOT** or **COOL** blowing.



Figure 6

- Use the top left hand switch to select **AUTO** or **OVERRIDE**.
  - Setting **AUTO** provides hot blowing when the ambient temperature is below 23°C – above 23°C it blows cool.
  - Setting **OVERRIDE** provides hot blowing at all times when the right hand switch is set to hot.
- When you have the desired setting, make sure the **POWER** is set to on

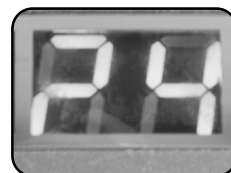

Figure 6a: Cool blowing over 23°C ambient

**Fig 7a:** Step 1



**Fig 7b:** Step 2



**Fig 7c:** Step 3



## Operation

This unit is easy to use. It starts and stops automatically when your hands are inserted into and removed from the unit. During operation the LED in the centre of the control panel will show activity and count down from 10 seconds to zero during the drying process – see *figure 8*.

When idle the LED displays the ambient temperature.

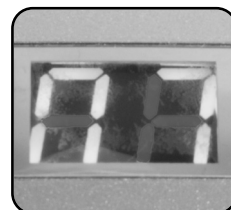

Figure 8: countdown on the LED, 10-0 seconds

### Drying your hands

Shake off excess water before inserting your hands into the unit.

#### Step 1

- Insert your hands into the unit with your fingers slightly spread. The hand dryer will start automatically as you do this – *figure 7a, Step 1*.

#### Step 2

- Slowly withdraw your spread fingers; you will feel the powerful air flow pressing against your hands as you do this – *figure 7b, Step 2*.

#### Step 3

- If your hands still feel wet repeat the first two steps – *figure 7c, Step 3*.

## Maintenance and cleaning

*Note: Always switch the unit off before cleaning or disconnect the unit from the electrical supply before completing any maintenance.*

### Emptying the water tank

From time to time you will need to empty the water tank located at the front/bottom of the machine. Simply grasp the tank by the handle and pull out. Then empty and replace the tank before further use.

- To prevent any potential clogging, pour 200cc (around 1 cup) of water through the drain hole to flush – see figure 9.
- Pull the drain tank out horizontally to ensure water does not spill.
- Remove the cover in the direction indicated, and empty – see figure 10.
- Wash out the interior with warm soapy water and dry.
- Close the water tank cover, and re-fit to the unit, making sure it is firmly seated.

### Cleaning the air filter

Remove the air filter by grasping the handle firmly and pulling out – see figure 11.

Clean the air filter by beating it lightly by hand or use a vacuum cleaner. The filter may be washed in warm soapy water if it is particularly dirty – ensure it is dry before re-installing.

Re-fit the filter by grasping firmly and inserting it all the way in until it is seated. *If it is not seated correctly, dirt or dust may enter the unit and shorten its service life.*

### General cleaning

It is recommended that all surfaces of the Heatstore HS5810 Tornado2 Hi-Speed Hand Dryer are cleaned regularly using a soft cloth and a non-abrasive/non-caustic cleaning fluid to avoid damaging the antibacterial coating.

### Test procedure

After maintenance, re-connect the electrical supply and ensure the unit is working correctly.



Figure 9

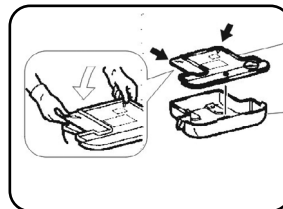

Figure 10

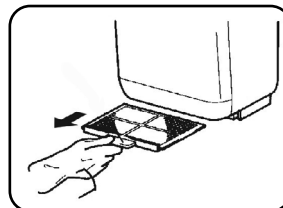

Figure 11

## Self diagnostics

Should a malfunction or error occur, the self-diagnostic indicator light – marked as **SERVICE** – on the right-hand side of the control panel will either light up or flash – see figure 12.

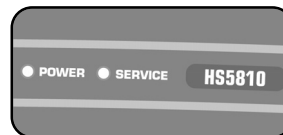

Figure 12

Turn off the power, wait approximately 40 seconds until all the indicators go off, then turn the power back on.

If the indicator still lights up or flashes, turn off the unit, disconnect the unit from the power, and contact Heatstore Technical.

## Troubleshooting

There are some basic actions you can take should your hand dryer malfunction.

PROBLEM	CHECK	ACTION
No air blows even if hands are inserted	<ul style="list-style-type: none"> <li>• Do the display indicators lights up?</li> <li>• Is the power switched on?</li> <li>• Are you inserting your hands correctly?</li> </ul>	<ul style="list-style-type: none"> <li>• Turn the ground-fault circuit breaker on.</li> <li>• Turn the power switch on.</li> <li>• Put hands all the way in — SEE FIGURE 7, PAGE 5.</li> </ul>
The unit does not stop blowing AUTO CUT-OUT AFTER 20 SECONDS	<ul style="list-style-type: none"> <li>• Is the sensor blocked or dirty?</li> </ul>	<ul style="list-style-type: none"> <li>• Turn the power switch off, and then, after all the lamps in the display have gone off, remove the dust matter.</li> </ul>
No hot air comes out	<ul style="list-style-type: none"> <li>• Check the switch settings are correct</li> </ul>	<ul style="list-style-type: none"> <li>• Turn the power switch off, check all the indicators in the display area have gone off (after approx. 40 seconds), then turn on the power switch again.</li> </ul>

If the above actions do not work, turn off the power and the RCCB circuit breaker, and call Heatstore Technical.

### **SPECIFICATION Heatstore Tornado 2 HS5810**

**Electrical:** Cool: 800W or hot: 1900W; 230/240V; 50Hz;

**Air Speed:** 95m/s  $\pm 5\%$ ;

**Drying Time:** 5-10 seconds;

**Dimensions/Weight:** 687(h) x 300(w) x 220 mm; 11kG

**Sound level:** 75dB



Waste electrical products should not be disposed of with household waste. Please recycle where facilities exist. Check with your local authority or retailer for recycling advice.

 **HEATSTORE**

Telephone: **0117 923 5375** Fax: **0117 923 5374**

Victoria Road, Avonmouth, Bristol BS11 9DB

[www.heatstore.co.uk](http://www.heatstore.co.uk)

ISSUE 1: 0413