

# Product Data Sheet



Product Code:	Issue No.	Issue Date:	Issue by:
<b>MC016T - MC250T</b>	G	<b>13.03.15</b>	<b>SH</b>

Description
<b>Triple Pole MCCB 16-250A 36kA</b>



General Characteristics	
Standards	EN60947-2 IEC947-2
Rated Current (In)	16, 20, 25, 32, 40, 50, 63, 80, 100, 125, 160, 200 & 250A
No. of poles	3
Rated operating voltage (Ue) - a.c. 50-60Hz	400V
Rated insulation voltage (Ui) - a.c. 50-60Hz	750V
Rated impulse withstand voltage (Uimp)	8kV
Utilisation Category	A
Rated Thermal adjustment	0.8-1xIn
Rated Magnetic Operation	16A-25A = 250A 32A-160A = 10xIn 200A-250A = 5-10xIn
Short Circuit rating (kA) - Icu (380-400V 50-60Hz)	36kA
Operating Short Circuit rating (kA) Ics	100% (400V~)
Mechanical life (ops)	>15000
Electrical life (ops)	>5000
Terminal cable capacity	>120mm <sup>2</sup> (box clamps)
Terminal Tightening Torque	6Nm
Weight	1.8Kg
Calibration Temperature	40C
Operating ambient temperature	-20C to +60C
Pollution Degree	III

## Product coding

MC	016	T
----	-----	---

Range	In	Frame
	16	Triple Pole
	20	
	25	
	32	
	40	
	50	
	63	
	80	
	100	
	125	
	160	
	200	
	250	

## Notes:

- 'Current limiting' MCCB design ensures fast disconnection of current under short circuit conditions.
- Icu test: O - t - CO where O=breaking operation, CO=closing operation and t=fixed time delay
- Ics test: O - t - CO - t - CO

# Product Data Sheet



Product Code:	Issue No.	Issue Date:	Issue by:
<b>MC016T - MC250T</b>	G	<b>13.03.15</b>	<b>SH</b>
Description			
<b>Triple Pole MCCB 16-250A 36kA</b>			

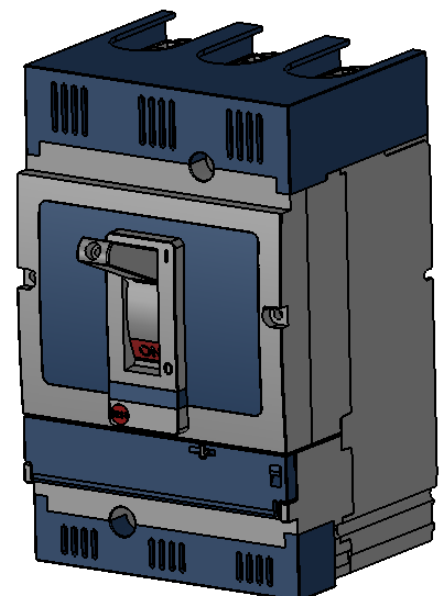
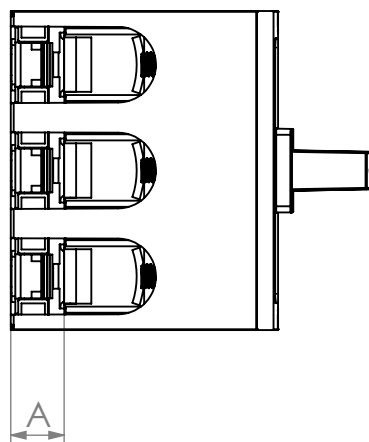
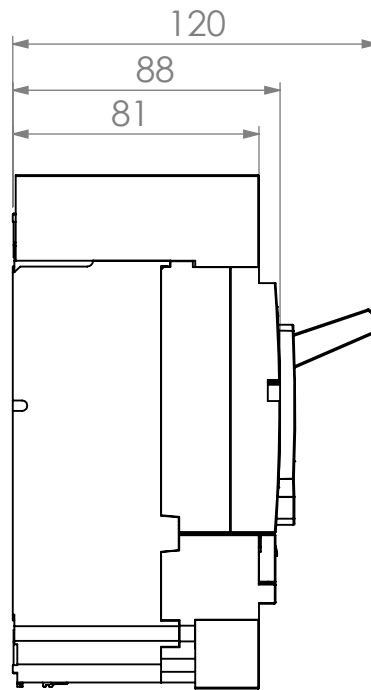
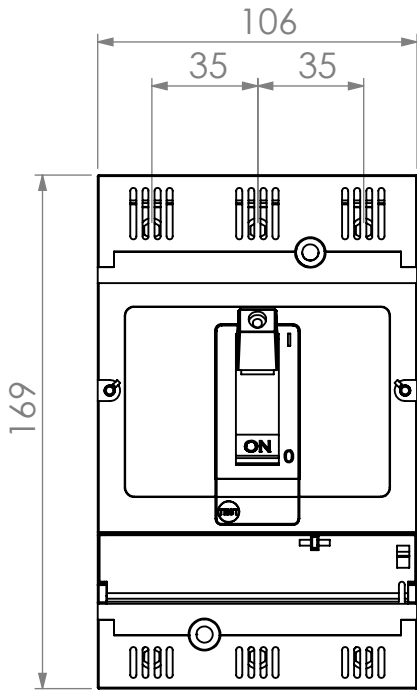

TERMINAL	A (mm)
Lower	28
Upper	25

# Product Data Sheet



Product Code:	Issue No.	Issue Date:	Issue by:
MC016T - MC250T	G	13.03.15	SH
Description			
Triple Pole MCCB 16-250A 36kA			

## Operating Characteristics

### Thermal / Magnetic Type Circuit Breaker

MC016T  
16A

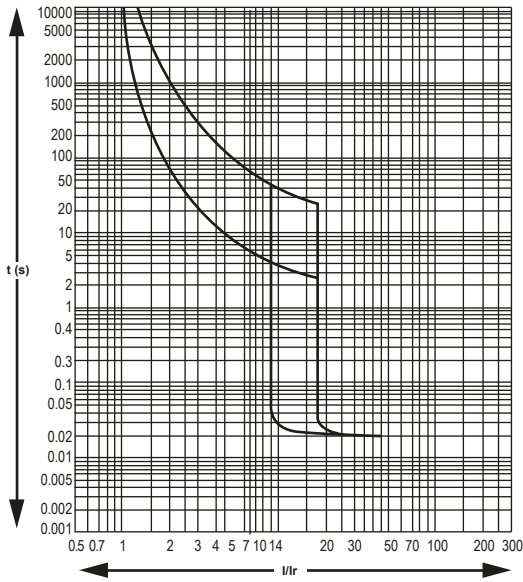

MC020T  
20A

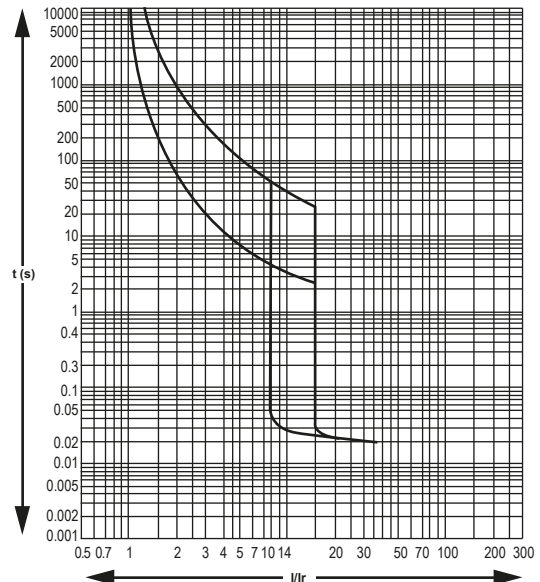

MC025T-MC160T  
25A-160A

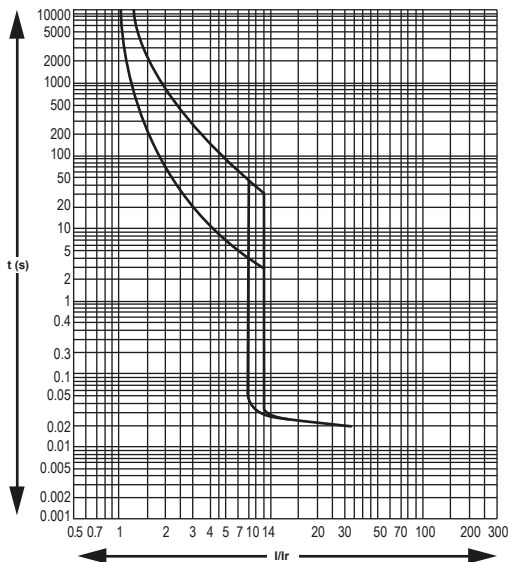

MC200T-MC250T  
200A-250A

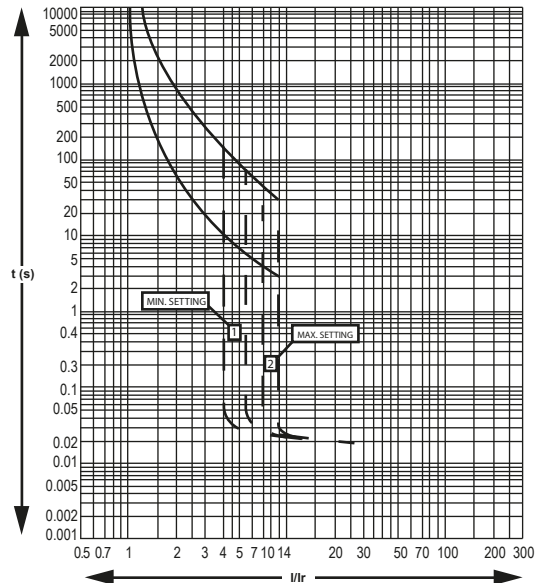

# Product Data Sheet



Product Code:	Issue No.	Issue Date:	Issue by:
MC016T - MC250T	G	13.03.15	SH

Description
Triple Pole MCCB 16-250A 36kA

## Operating Characteristics

$I_{peak}$  Curve

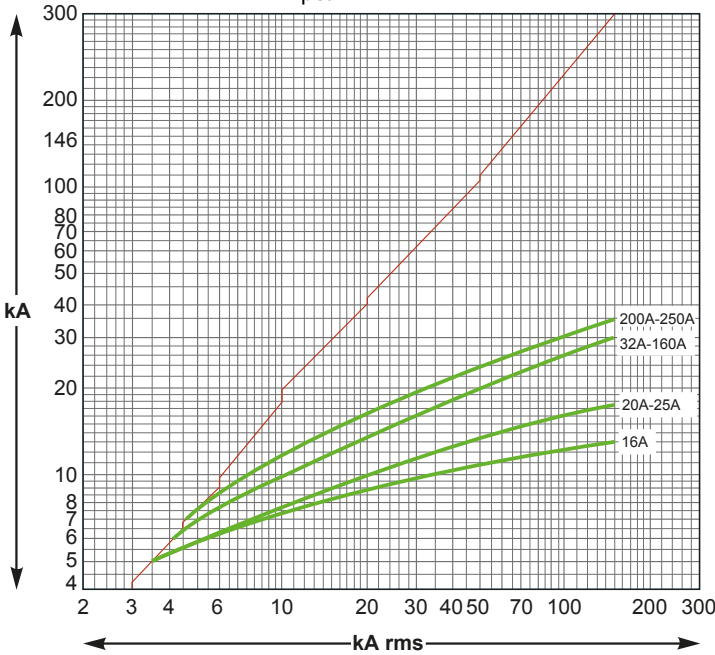

$I^2t$  Curve

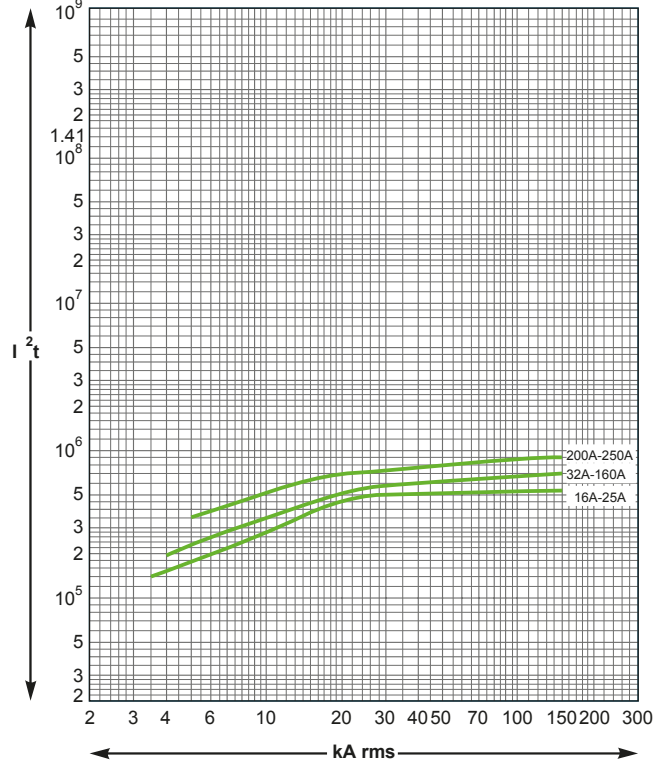

## Maximum Earth Fault Loop Impedance Values @ 218.5V (230V x 0.95 Cmin)

Rating	Short-Time (Im)	Thermal Adjustment (Ir)	Thermal Setting (A)	Upper Limit Zs (Ohms)		Rating	Short-Time (Im)	Thermal Adjustment (Ir)	Thermal Setting (A)	Upper Limit Zs (Ohms)	
				0.4s	5s					0.4s	5s
16A	250	1	16	0.87	1.82	80A	800	1	80	0.28	0.44
		0.9	14					0.9	72		
		0.8	13					0.8	64		
20A	250	1	20	0.87	1.82	100A	1000	1	100	0.22	0.30
		0.9	18					0.9	90		
		0.8	16					0.8	80		
25A	250	1	25	0.87	1.82	125A	1250	1	125	0.18	0.21
		0.9	23					0.9	113		
		0.8	20					0.8	100		
32A	320	1	32	0.68	1.45	160A	1600	1	160	0.13	0.17
		0.9	29					0.9	144		
		0.8	26					0.8	128		
40A	400	1	40	0.55	1.09	200A	1000-2000	1	200	0.11	0.13
		0.9	36					0.9	180		
		0.8	32					0.8	160		
50A	500	1	50	0.44	0.87	250A	1250-2500	1	250	0.087	0.09
		0.9	45					0.9	225		
		0.8	40					0.8	200		
63A	630	1	63	0.35	0.72						
		0.9	57								
		0.8	50								

Short-Time current +/-20%